



Dasher board systems

INNOVATION AND USER-SAFETY

engo develops and produces IIHF-conform, tested flexible dasher board systems for all kinds of indoor and outdoor ice rinks.

engo
ice arena equipment

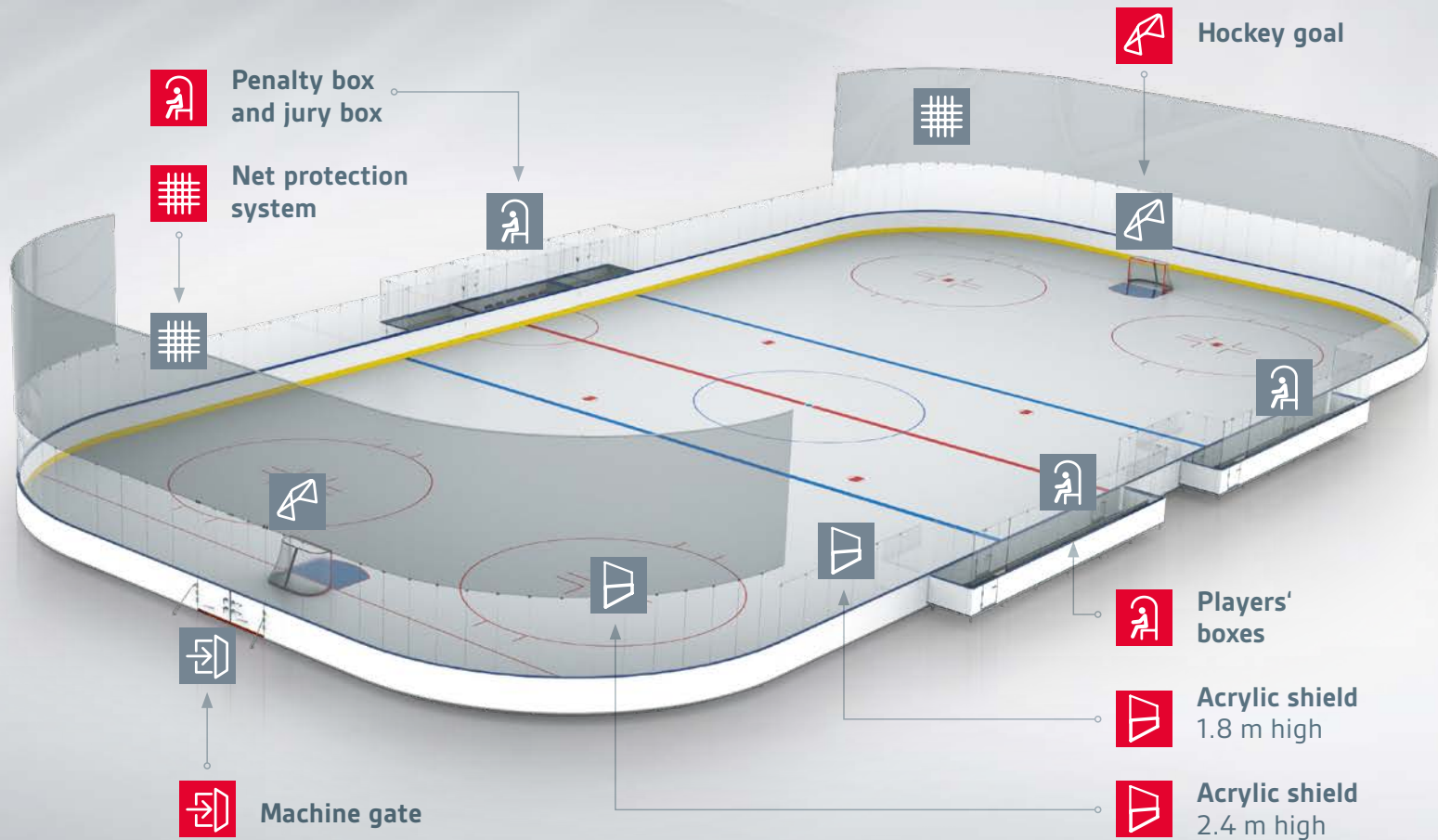

ANCHORING

ANCHORING AND INSTALLMENT POSITIONS

We provide various anchoring systems for your icerink. All of our dasher boards are individually planned and as such can be adapted specifically for your building. This is advantageous in newly constructed facilities. The options include: Anchoring systems with ice dam; Installation systems on barriers; Installations into the ice with steel plates and most commonly immersed adhesive anchors.



Alternatively
Immersed steel rail in concrete

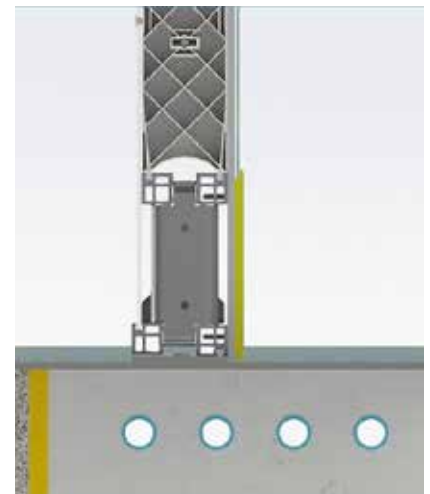

Installation into ice with steel plates

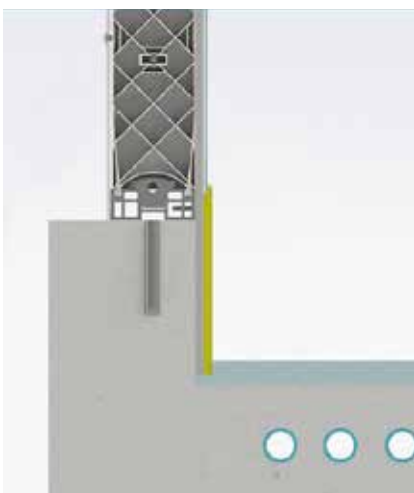

Installation on a barrier

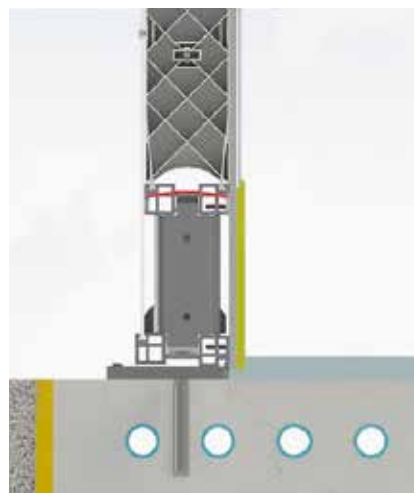

Immersed adhesive anchors

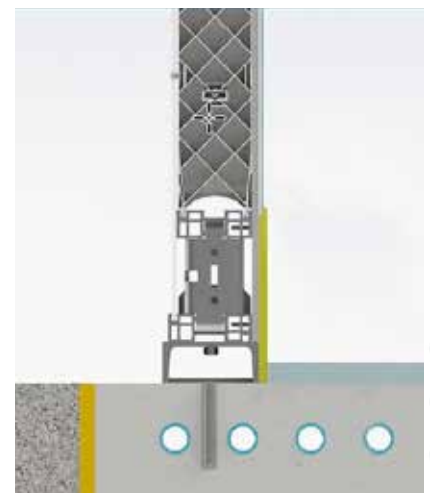

Anchoring system with ice dam